

# DM series Bowl Dimensions

Diagrams show counter-clockwise orientation

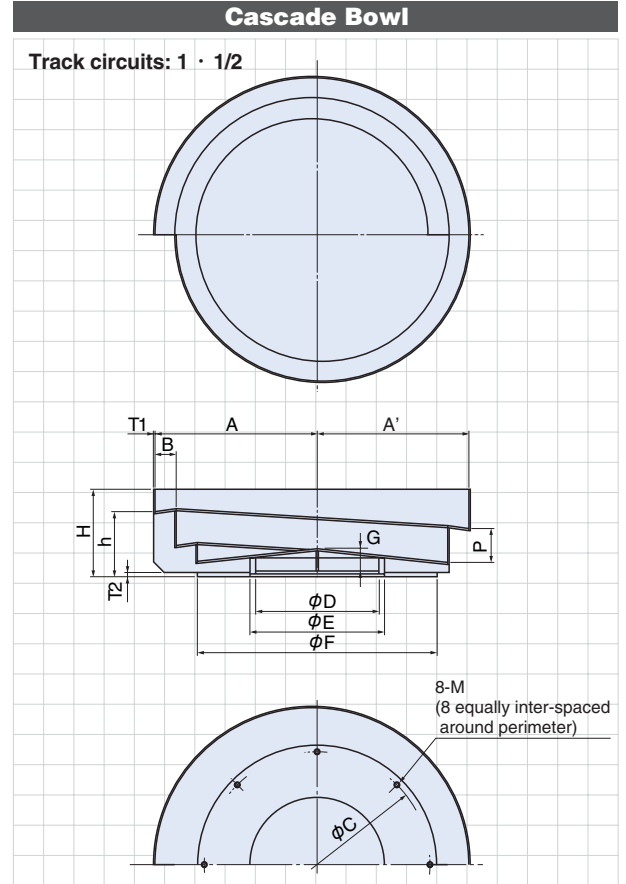
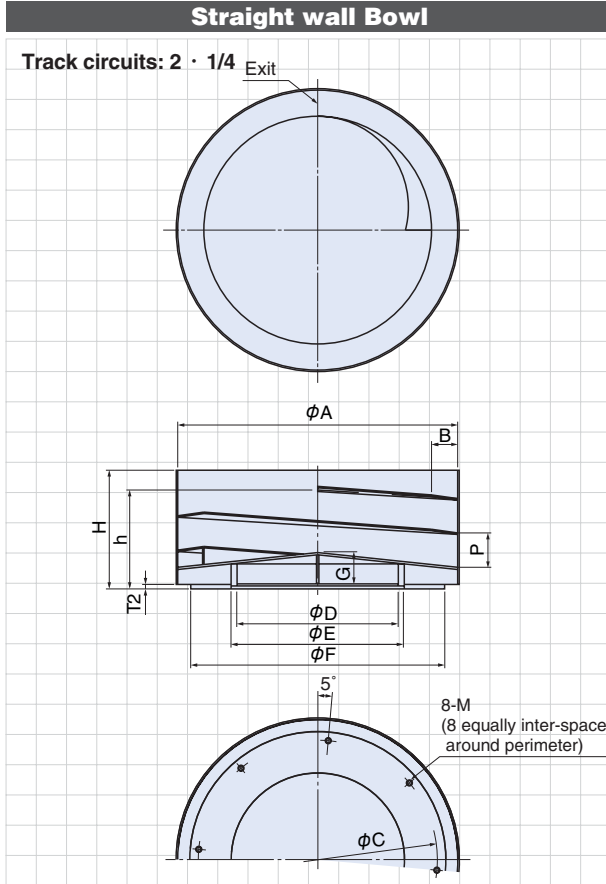

## Straight wall Bowl Dimensions Chart

Model	$\phi A$	B	$\phi C$	$\phi D$	$\phi E$	$\phi F$	G	H	h	M	P	T2	Approx. weight (kg)	Capacity (ℓ)
DM-30C	300	25	270	174.7	190.7	290	40	129	105	M8	36	6	6.5	0.8
DM-38C	375	35	320	216	232	340	48	159	133	M8	46	6	10.0	1.7
DM-45C	450	40	365	282.5	298.5	390	60	197	163	M10	56	9	18.0	3.0
DM-65C	650	65	600	363.6	406.4	630	-	302	249.5	M12	90	12	54.0	10.0

Unit: mm

## Cascade Bowl Dimensions Chart

Model	A	A'	B	$\phi C$	$\phi D$	$\phi E$	$\phi F$	G	H	h	M	P	T1	T2	Approx. weight (kg)	Capacity (ℓ)
DM-30C	180	167.5	25	270	143	159	290	32	99	74	M8	38	2	6	5.5	1.6
DM-38C	230	215	30	320	174.7	190.7	340	40	124	92	M8	48	2	6	8.5	3.5
DM-45C	280	260	40	365	216	232	390	51	157	116	M10	58	2	9	13.5	6.0
DM-65C	445	405	80	600	363.6	406.4	630	-	267	197	M12	100	3	12	52.0	18.0

Unit: mm

- Notes
- \*1 Bowls are made of stainless steel.
  - \*2 Bowls available with clockwise or counter-clockwise orientation.
  - \*3 Charged capacity varies according to the type of workpiece.
  - \*4 When supplied unprocessed, neither inside nor outside has been surface-treated.
  - \*5 When supplying processed, specialized bowls other than standard bowls above can be manufactured.

## Straight wall Bowl Selection Guide

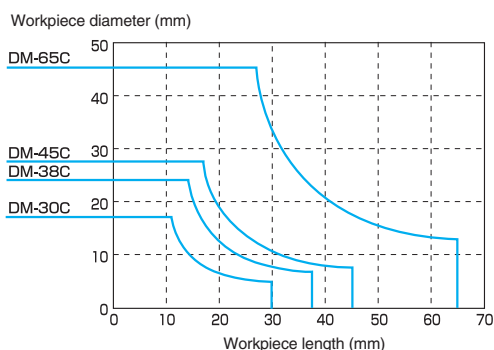

## Cascade Bowl Selection Guide

